

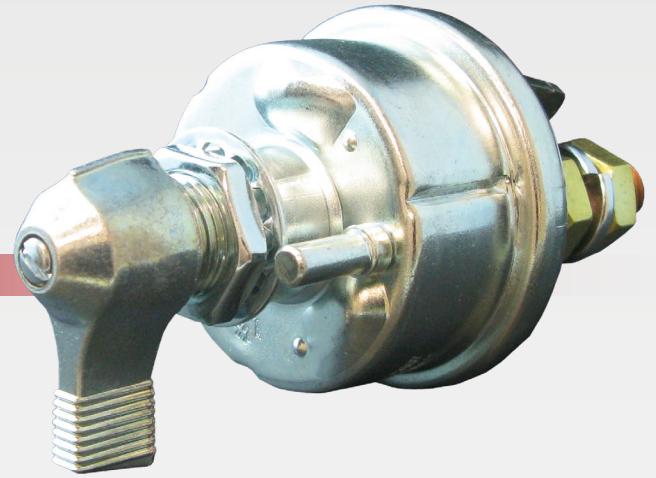

## Heavy Duty Lever Type Isolator Switch

Cole Hersee Co. #75907B

www.colehersee.com.au



### DESCRIPTION

DPST heavy duty on/off battery isolator switch with indexing post.

6-36V, 300A continuous, 2000A intermittent.

Features silver contacts with chrome lever, weather resistant O'ring seal on mounting shaft. 3/4" mounting stem. Small terminals 20A @ 12V.

### FEATURES

- Disconnects the battery and the alternator or generator field
- Indexing pin aligns switch and prevents rotation
- DPST configuration
- Weather resistant, O-ring sealed
- Silver contacts. Chrome lever
- Field terminals 20 Amp continuous
- Suits panel thickness to 6.5mm
- Mounting stem 3/4" - 24 thread, L 13mm
- 2 x field stud 10 - 32, 2 x battery stud 1/2" - 20

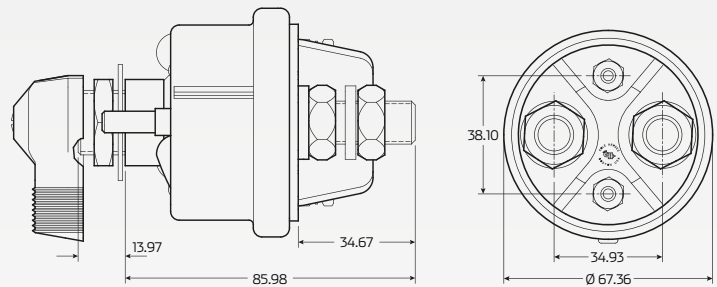

\*All measurements are in mm

### TECHNICAL SPECIFICATIONS

<b>Voltage</b>	• 6 - 36V multi-volt	<b>Housing Material</b>	• Steel plated casing, chrome lever
<b>Maximum Amperage</b>	• 2000A Intermittent	<b>Field Studs Size</b>	• 2 x studs 10 - 32
<b>Continuous Amperage</b>	• 300A continuous	<b>Battery Studs Size</b>	• 2 x studs 1-2" - 20
<b>Field Terminals Amperage</b>	• Field terminals 20A continuous	<b>Stud Torque</b>	• 4.4 to 7.4 ft lbs (6-10 Nm)
<b>Configuration</b>	• DPST	<b>Operating Temperature</b>	• -40°C to 85°C
<b>Dimensions</b>	• 110mm x 67mm Ø	<b>Mounting Stem</b>	• 3/4" - 24 thread, L 13mm
<b>Contact Material</b>	• Silver contacts	<b>Weatherproof</b>	• Yes, O-ring sealed