



Lever Type Dual Battery Isolator Switch

Cole Hersee Co. #75912B

www.colehersee.com.au

DESCRIPTION

DPST on/off dual battery isolator switch with indexing post.

6-36V, 125A continuous x 2, 750A intermittent x 2. Has 4 battery studs. This switch can be used to switch positive and negative at the same time or for 2 separate circuits. Features silver contacts with chrome lever, weather resistant O'ring seal on mounting shaft. 3/4" mounting stem.

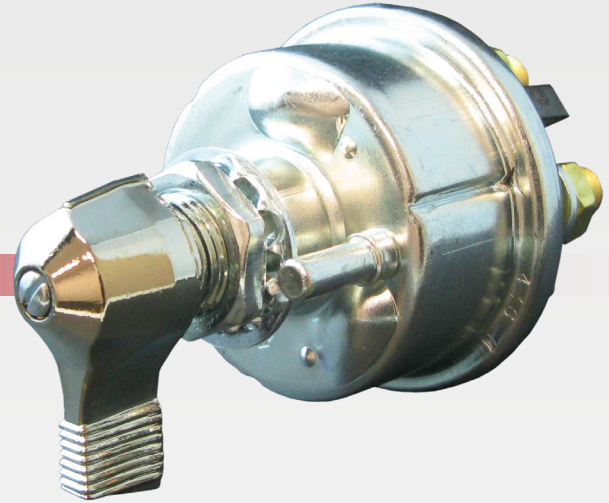

FEATURES

- Disconnects the battery and the alternator or generator field
- Controls two systems, or it can be used to disconnect both positive and negative of the same circuits
- DPST configuration
- Silver contacts. chrome lever
- Indexing pin aligns switch and prevents rotation
- Suits panel thickness to 6.5mm
- Weather resistant, O-ring sealed
- Mounting stem 3/4" - 24 thread, L 13mm
- 4 x battery stud 3/8" - 24

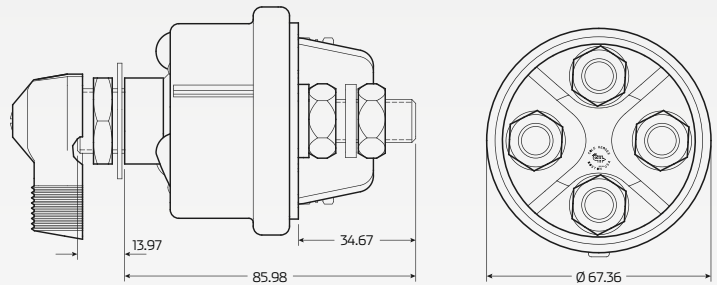

*All measurements are in mm

TECHNICAL SPECIFICATIONS

Voltage	• 6 - 36V multi-volt	Housing Material	• Steel plated casing, chrome lever
Maximum Amperage	• 750A Intermittent x 2	Stud Size	• Battery studs: 3/8" - 24
Continuous Amperage	• 125A continuous x 2	Stud Torque	• 4.4 to 7.4 ft lbs (6-10 Nm)
Configuration	• DPST	Operating Temperature	• -40°C to 85°C
Dimensions	• 110mm x 67mm Ø	Mounting Stem	• 3/4" - 24 thread, L 13mm
Contact Material	• Silver contacts	Weatherproof	• Yes, O-ring sealed