

NARVA® 10-33V LED
THE VISION TO GO FURTHER Amber Front Marker
#91422 / 91423

www.narva.com.au

DESCRIPTION

LED amber front marker lamp. Multivolt with 10-33V input voltage range. Black mounting bracket with an estimated 100,000 hours of LED life.

Comes installed with a 500mm twin sheathed cable. Dust and water resistant up to IP66 & IP68 rating. ADR approved. 5 year manufacturer warranty.



FEATURES

- Multivolt: 10 - 33 Volt
- 14 LED's side amber marker lamp
- Expected up to 100,000 hours LED life
- Black deflector mounting base
- Equipped with 500mm of twin sheathed cable
- IP66 & IP68 Dust & water resistant
- Available in an optional 2.5m wired cable (P/N 91423)
- 5 year manufacturer warranty

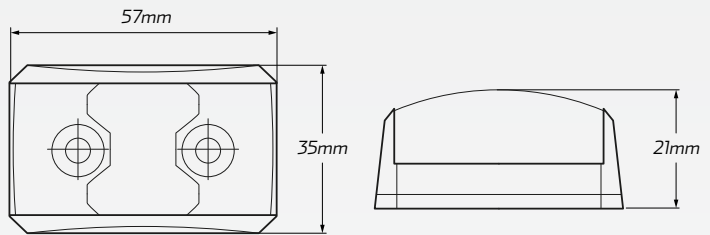

TECHNICAL SPECIFICATIONS

Voltage Range	• 10 - 33 Volt	Dimensions	• 35mm H x 57mm W x 21mm D
Current Draw	• 0.04 Amps	Wiring	• Pre-wired twin sheath
Mounting	• Surface mount	Mounting Hole	• 28.5mm CTC
IP Rating	• IP66 & IP68 rated	Approvals	• Horizontal: 45/00 41758 • Horizontal/Vertical: 49/00 41989 • Horizontal: 74/00 41777
Candela Rating	• 82		

PART NUMBER

Part Number.	Quantity	Wire Length	Description
91422	• 1 lamp	• 500mm twin sheath	• LED amber front marker lamp with 500mm twin sheathed cable.
91422BL	• 1 lamp	• 500mm twin sheath	• LED amber front marker lamp with 500mm twin sheathed cable. Blister pack.
91423	• 1 lamp	• 2.5m twin sheath	• LED amber front marker lamp with 2.5m twin sheathed cable. Blister pack.