

**NARVA**® 10-33V LED  
THE VISION TO GO FURTHER Amber Side Marker  
#91442BL / 91443

www.narva.com.au

**DESCRIPTION**

LED amber side marker lamp. Multivolt with 10-33V input voltage range. Black mounting bracket with estimated of 100,000 hours LED life.

Comes installed with a 500mm twin sheathed cable. Dust and water resistant up to IP66 & IP68 rated. ADR approved.

5 year manufacturer warranty.



**FEATURES**

- Multivolt: 10 - 33 Volt
- 14 LED's side direction indicator lamp
- Expected up to 100,000 hours LED life
- Black deflector mounting base
- Equipped with 500mm of twin sheathed cable
- IP66 & IP68 Dust & water resistant
- Available in an optional 2.5m wired cable (P/N 91423)
- 5 year manufacturer warranty

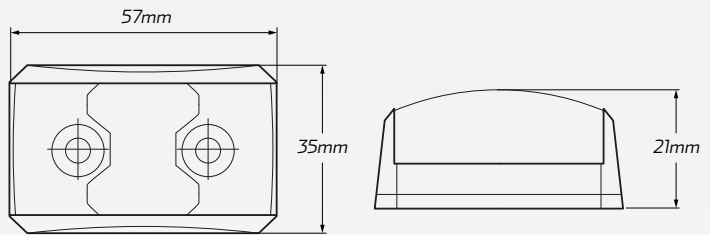

**TECHNICAL SPECIFICATIONS**

<b>Voltage Range</b>	• 10 - 33 Volt	<b>Dimensions</b>	• 35mm H x 57mm W x 21mm D
<b>Current Draw</b>	• 0.04 Amps	<b>Wiring</b>	• Pre-wired twin sheath
<b>Mounting</b>	• Surface mount	<b>Mounting Hole</b>	• 28.5mm CTC
<b>IP Rating</b>	• IP66 & IP68 rated	<b>Approvals</b>	• ADR 6/00 41871 (Cat 5)
<b>Candela Rating</b>	• 18		

**PART NUMBER**

Part Number.	Quantity	Wire Length	Description
91442BL	• 1 lamp	• 500mm twin sheath	• LED amber side marker lamp with 500mm twin sheathed cable. Blister pack.
91443	• 1 lamp	• 2.5m twin sheath	• LED amber side marker lamp with 2.5m twin sheathed cable. Blister pack.