

NARVA® Model 16 LED Red/
Amber Side Marker
#91602BL

www.narva.com.au

DESCRIPTION

LED red/amber side marker lamp. Multivolt with 9-33V input voltage range, suits 12/24 Volt applications. Black mounting bracket with an estimated 100,000 hours of LED life.

Comes installed with a 500mm pre-wired cable. Low current draw. Dust and water resistant up to IP66 & IP68 rating. ADR approved.

5 year manufacturer warranty.



Clear lens when not illuminated

FEATURES

- Multivolt: 9 - 33 Volt
- Expected up to 100,000 hours LED life
- Oval black deflector mounting base
- Model 16 unbreakable clip on polycarbonate lens
- Equipped with 500mm of pre-wired cable
- Clear lens when not illuminated
- IP66 & IP68 dust & water resistant
- 5 year manufacturer warranty



5 Year Warranty

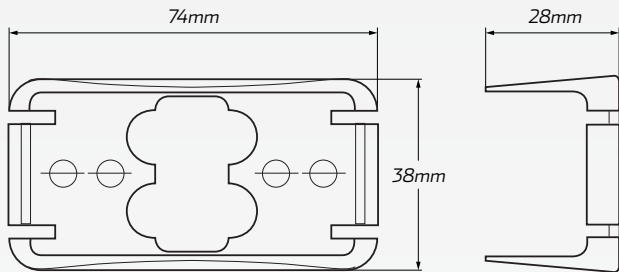

Model 16 combines amber LED's with clear lenses. Meets a wide range of ADR requirements through one common mounting base.

TECHNICAL SPECIFICATIONS

Voltage Range	• 9 - 33 Volt
Current Draw	• 0.04 Amps
Mounting	• Surface mount
IP Rating	• IP66 & IP68 rated
Candela Rating	• 11

Dimensions	• 38mm H x 74mm W x 28mm D
Wiring	• Pre-wired 500mm cable
Mounting Hole	• 28.5mm / 50.8mm CTC
Estimated Lifetime	• 100,000 hours
Approvals	• ADR 45/00 31582