

QVEE Male Plug-in Fusible Link
AUTOMOTIVE | MINING | MARINE
#QVBTF

www.qvee.com.au

DESCRIPTION

The QVBTF series is a 32V DC plug-in fusible link with male terminals. Features element window. RoHS approved. Suitable for all automotive applications.



TECHNICAL SPECIFICATIONS

I.R.	• 1000A at 32V DC	
Voltage	• 32V DC	
Approvals	• ISO 8820 / JASO D612 / RoHS	
Dimensions	• 43.2mm H x 22.2mm W x 15mm D	
Time Characteristic % of Amp Rating	Opening Time	
	Min. Time	Max. Time
100%	• 100 Hours	--
200%	• 5 Seconds	• 60 Seconds
350%	• 0.2 Seconds	• 7 Seconds
600%	• 0.04 Seconds	• 1 Seconds

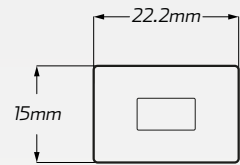

DIMENSIONS

- Height: 43.2mm
- Width: 22.2mm
- Depth: 15mm

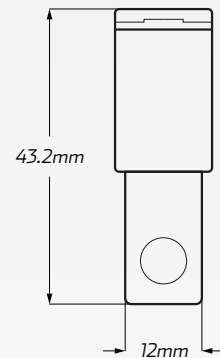
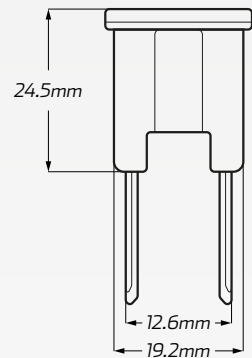

PART NUMBERS

Part Number.	Amperage	Colour	Description
QVBTF030	• 30 Amp	• Pink	• 30 Amp pink male plug-in fusible link
QVBTF040	• 40 Amp	• Green	• 40 Amp green male plug-in fusible link
QVBTF050	• 50 Amp	• Red	• 50 Amp red male plug-in fusible link
QVBTF060	• 60 Amp	• Yellow	• 60 Amp yellow male plug-in fusible link
QVBTF070	• 70 Amp	• Brown	• 70 Amp brown male plug-in fusible link
QVBTF080	• 80 Amp	• Black	• 80 Amp black male plug-in fusible link
QVBTF100	• 100 Amp	• Blue	• 100 Amp blue male plug-in fusible link
QVBTF120	• 120 Amp	• Grey	• 120 Amp grey male plug-in fusible link