

QVEE

AUTOMOTIVE | MINING | MARINE

www.qvee.com.au

Battery Lug Covers

Sold Individually



DESCRIPTION

QVEE's battery lug covers are designed to optimally protect terminals from shocks and short circuits. Each cover includes a finger tab for easy installation and removal.

Available in both red and black.

Options ranges to suit cables from 3.5mm up to 18mm O.D.

(Please refer to part number table below for cable diameter)

TECHNICAL SPECIFICATIONS

- Optimally protect terminals from shocks and short circuits
- Suits most standard sized battery lugs
- Available in both red and black for colour identification
- Finger tab for easy installation and removal

Dimension Diagram

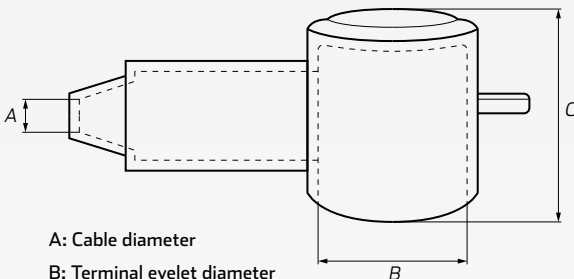

A: Cable diameter

B: Terminal eyelet diameter

C: Battery cover height

General Specifications

Material	• PVC
Operating Temperature	• -48° Celcius to 168° Celcius
Specific Gravity	• 1.34
Shore Durometer	• Shore A 10 Sec. 65
Ultimate Elongation	• 400%
Tensile Strength	• 1550 PSI
Dielectric Strength	• 453 v/.mil
UL Rating	• UL - V2

PART NUMBERS

Black (-) Part No.	Red (+) Part No.	Cable Ø (A)	Eyelet Ø (B)	Height (C)	Description
SY2960-BLK	SY2960-RED	• 3.5mm	• 14mm	• 19mm	• Lug cover to suit cable up to 3.5mm O.D. 14mm Ø eyelet.
SY2965-BLK	SY2965-RED	• 7.5mm	• 18mm	• 22mm	• Lug cover to suit cable up to 7.5mm O.D. 18mm Ø eyelet.
SY2968-BLK	SY2968-RED	• 12.5mm	• 22mm	• 26.5mm	• Lug cover to suit cable up to 12.5mm O.D. 22mm Ø eyelet.
SY2970-BLK	SY2970-RED	• 12.5mm	• 28mm	• 33.5mm	• Lug cover to suit cable up to 12.5mm O.D. 28mm Ø eyelet.
SY2975-BLK	SY2975-RED	• 18mm	• 32mm	• 38mm	• Lug cover to suit cable up to 18mm O.D. 32mm Ø eyelet.